

Hewland FTR Shaft Assemblies

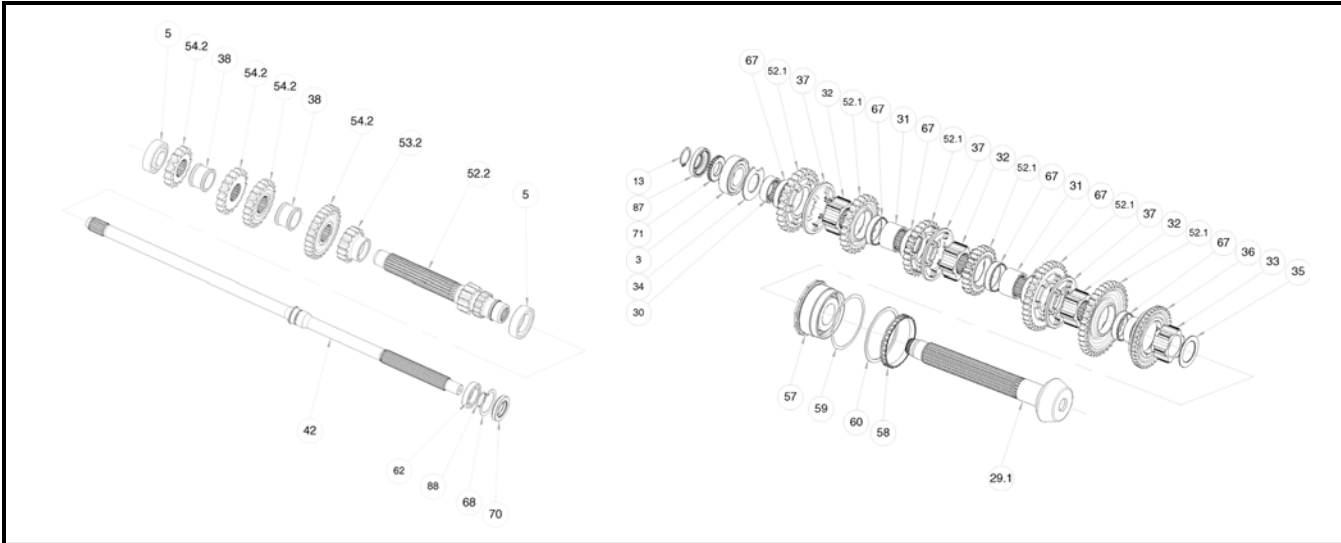

ITEM NUMBER	WRD NUMBER	NEWLAND NUMBER	DESCRIPTION	PRICE
3	WRD-SIN-015	BEA-002	BEARING - PINION SHAFT REAR	
13	WRD-SIN-016	DGB239-0	CIRCLIP	
30	WRD-HL-FTR225	HFTR225	BEARING INNER TRACK	\$146.00
31	WRD-HL-FTR226	HFTR226	BEARING INNER TRACK	\$146.00
32	WRD-HL-FTR227	HFTR227	HUB	\$306.00
33	WRD-HL-FTR228	HFTR228	REVERSE HUB	\$249.00
34	WRD-HL-LD52294	HLD5-2294	THRUST WASHER	\$82.00
35	WRD-HL-FTR2291-A	HFTR2291-063	SPACER FORK SETTING 0.063	\$25.00
35	WRD-HL-FTR2291-B	HFTR2291-068	SPACER FORK SETTING 0.068	\$25.00
35	WRD-HL-FTR2291-C	HFTR2291-073	SPACER FORK SETTING 0.073	\$25.00
35	WRD-HL-FTR2291-D	HFTR2291-078	SPACER FORK SETTING 0.078	\$25.00
35	WRD-HL-FTR2291-E	HFTR2291-083	SPACER FORK SETTING 0.083	\$25.00
35	WRD-HL-FTR2291-F	HFTR2291-088	SPACER FORK SETTING 0.088	\$25.00
36	WRD-HL-FTR231	HFTR231	REVERSE SLIDING GEAR	\$234.00
37	WRD-HL-FTR232	HFTR232	CLUTCH RING	\$210.00
52.1		HFTR233	SEE PAGE 30	
52.2		HFTR234	SEE PAGE 30	
53.2		HFTR235-1	SEE PAGE 30	
54.2		HFTR235	SEE PAGE 30	
57	WRD-HL-C82221HB	HHC8-2221HB	PINION BEARING, NEW STYLE	\$97.50
58	WRD-HL-C82221A	HHC8-222-1A	RING NUT	\$35.00
59	WRD-SIN-104(X)	HHC8-222-2	PINION BEARING SHIM	\$2.25
60	WRD-HL-C82222A	HHC8-222-2A	RING NUT WASHER	\$7.50
67	WRD-HL-LD2261	LD226-1	NEEDLE BEARING - RATIOS	\$19.00
71	WRD-HL-FTR230	HFTR230	PINION SHAFT NUT	\$47.00
87	WRD-SIN-017	HP-M-4026	LOCKING RING	\$180.00
5	WRD-SIN-018	BEA-159	LAYSHAFT BEARING	\$47.50
38	WRD-HL-FTR2341	HFTR2341	SPACER, INPUT SHAFT	\$80.00
42	WRD-HL-FTR2398	HFTR2398	INPUT SHAFT, STAR MAZDA	\$577.00
42	WRD-HL-FTR2392	HFTR2392	INPUT SHAFT, BMW	\$577.00
62	WRD-SIN-019	HP-M-8008	BARREL BEARING	\$50.00
68	WRD-SIN-020	LD244-10	CIRCLIP	\$0.95
70	WRD-SIN-021	LIP-043	OIL SEAL	\$15.00